



Nozzle Plug



3115 3116



3118 3119



3120 3121

Nozzle Cap

Dropper Cap



4021 4315

Spouted Cap



4715 4612 4629

## Spouted, Dropper and Nozzle Caps

- Long Spouts with long nozzle & re-closure tip.
- Long Spout closure tip available in white LDPE only.
- Dropper Caps with captive closure for single drop dispensing.
- Nozzle Plugs & Caps for single drop dispensing.
- Available from stock in white with colours available to order.
- Typical uses include lubricants, adhesives, inks, chemicals, pharmaceuticals, veterinary preparations, hair care products etc.

### Details

#### Spouted, Dropper and Nozzle Caps

Catalogue Number	Type	Neck Size	H Overall Height	D Diameter	Material
4715	Spouted Cap	15mm R4	48	18	Polypropylene
4612	"	18mm R4	62	22	"
4629	"	20mm R4	81	24	"
4021	Dropper Cap	Snap-On	26	19	White LDPE
4315	"	15mm R4	28	18	"
3115	Nozzle Plug	15mm	21	11.4	Natural LDPE
3116	Nozzle Cap	15mm R4	25	18	Polypropylene
3118	Nozzle Plug	18mm	24	12.5	Natural LDPE
3119	Nozzle Cap	18mm R4	29	21	Polypropylene
3120	Nozzle Plug	20mm	25	17.4	Natural LDPE
3121	Nozzle Cap	20mm R4	35	24	Polypropylene

Dimensions in mm

### Technical

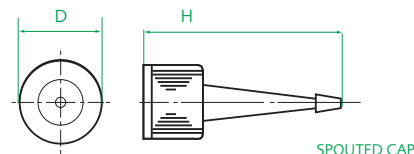

SPOUDED CAP

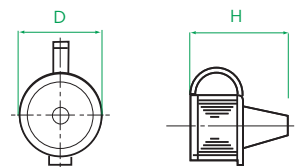

DROPPER CAP

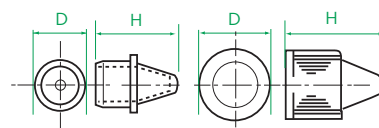

NOZZLE PLUG & CAP



Manufactured from recyclable plastics.

From Stock

SDCNPC8

**Measom Freer**  
packaging quality